

# FRANKE FILTERFLOW

## Changing the cartridge – Minerva Kettle Tap

### Cartridge Replacement Cycle

The recommended filter cartridge change cycle is 6 months.

**Important:** The period between cartridge replacements is not guaranteed; it is an estimate based on filtering mains water of average quality. Please bear in mind that water quality varies from locality to locality and situation to situation. In areas with higher than average turbidity (particle contamination) more frequent cartridge changes may be necessary.

**Preparation.** No special tools are required for this operation. All you will need is a suitable receptacle to catch any spillage and a cloth or a sponge handy. A rubber glove is provided to hold the wet cartridge.

**Most Important!** Switch off the mains electricity supply to the boiler.

**Lubricating the rubber seals.** For ease of assembly we recommend that a film of silicone grease is applied to the filter housing 'O' Seal, at least every other cartridge change, to maintain the smooth operation of the unit. **Important note** Only a WRAS approved silicon lubricant should be used for this purpose. Small tubes of a WRAS approved silicon grease can be purchased from Franke FilterFlow at [www.FrankeFilterFlow.co.uk](http://www.FrankeFilterFlow.co.uk)

**Disposing of the Spent Cartridge.** You may dispose of the cartridge in your normal household waste. The carbon components of the Franke 07 cartridge are biodegradable. You are welcome to return either the plastic parts or the complete cartridge to Franke FilterFlow for recycling. Should you decide to return the cartridge please allow it to dry naturally and return it in the original packaging.

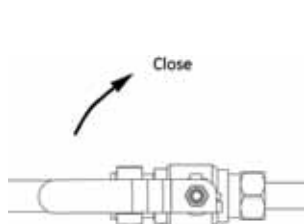

1. Locate the shut-off valve with the green handle adjacent to the inlet of the filter housing and turn off the mains water supply to the filter housing.

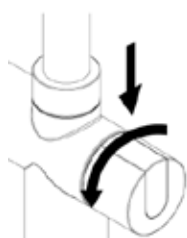

2. Turn the kettle tap boiling water handle to the "ON" position for a few seconds to release the pressure in the system.

**Important note.** If the pressure is not released it will not be possible to unscrew the filter housing sump from the head.



3. Place a bowl under the filter housing. Grip the sump firmly and turn it firmly to the left to break the seal. Lower the sump carefully sufficient to expose enough of the cartridge to grip it the fingers of your free hand.

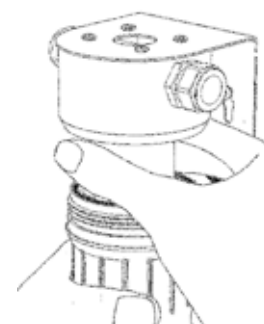

4. Unscrew the filter cartridge until it comes free. Carefully remove the sump with the cartridge inside. Remove the cartridge and discard the water in the sump. Dispose of the spent cartridge.

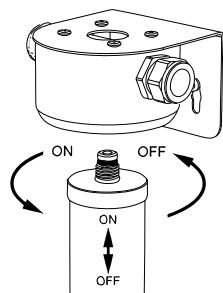

5. Reverse the removal procedure: install the new cartridge, taking care not to over-tighten it, and refit the sump.

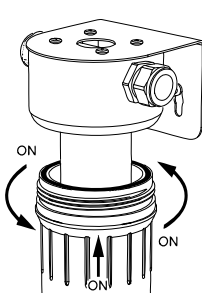

6. Tighten the sump firmly sufficient to make a water tight seal.

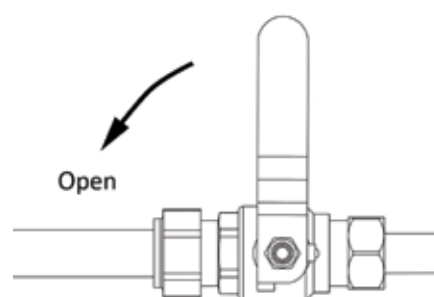

7. Turn the water supply 'on' and check the system carefully for leaks. Turn on the electricity supply to the boiler.



KITCHEN  
SYSTEMS

Franke FilterFlow, 3 Old Winery Business Park, Chapel Street, Cawston, Norfolk NR10 4FE  
Phone +44 (0)808 165 0008 Fax +44 (0)844 358 0166 Email [info@frankefilterflow.com](mailto:info@frankefilterflow.com)  
[www.frankefilterflow.co.uk](http://www.frankefilterflow.co.uk)