

Franke FilterFlow

Olympus & Kubus Spout Seal Kit Change Guide

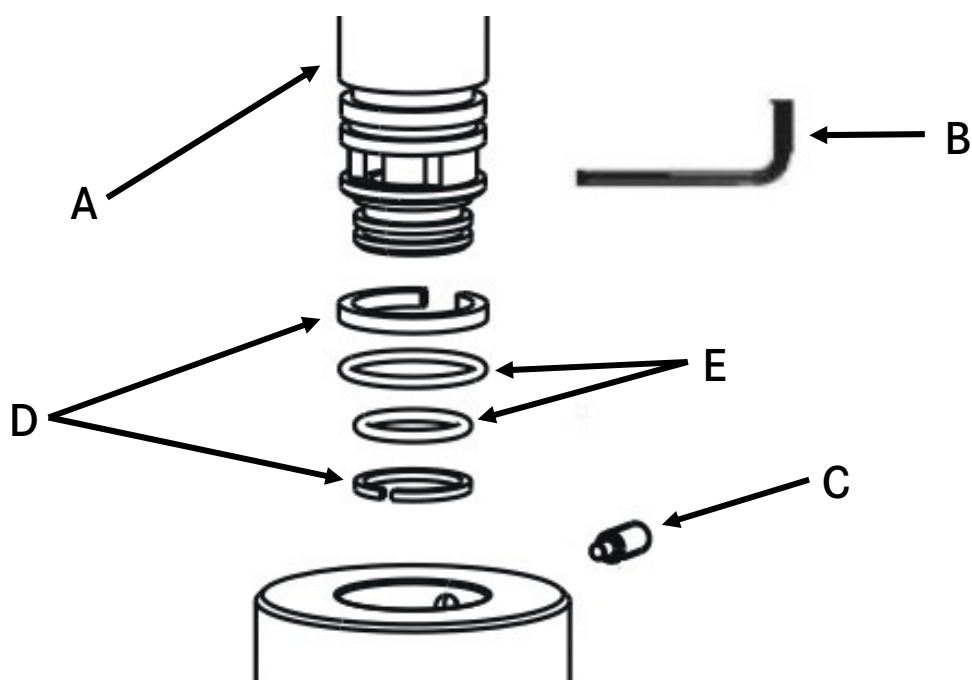

Before you begin

Replacing the spout seals is a straightforward procedure for any competent handyperson. However, should you have any doubts about your ability to tackle the task we suggest you engage a suitably qualified professional.

The tools you will need

1. 2.5mm Allen Key

The spout seal kit change procedure

1. Turn off the water supply to the tap.
2. Use the 2.5mm Allen key (B) to unscrew the grub screw (C) located on the back of the tap where the spout enters the tap body.
3. Remove the spout (A) by pulling it securely upwards.
4. Remove the plastic bearing rings (D) and replace using the matching bearing rings from the kit. Align the gap in the larger bearing ring with the hole in the tap body.
5. Remove the O-Seals (E) and replace them with the new seals.
6. Insert the spout back into the body of the tap.
7. Replace the grub screw. This only needs to be inserted far enough to prevent the spout from coming out, it is not intended to screw into the spout surface.
8. Turn the water supply back on and check for leaks.

FRANKE

FRANKE FILTERFLOW

KITCHEN
SYSTEMS

Franke FilterFlow 3 Old Winery Business Park, Chapel Street,
Cawston, Norfolk, NR10 4FE
Phone +44 (0) 808 165 0008 Fax +44 (0) 844 358 0166
Email: info@frankefilterflow.co.uk