

Franke Filterflow

Valve Change Guide - Zurich

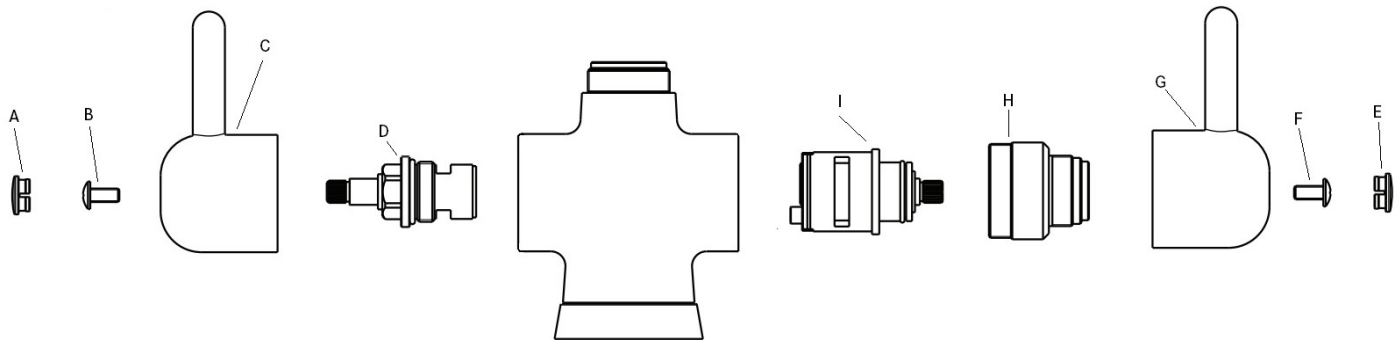

Before you begin

Replacing the valves of a Filterflow tap is a straightforward procedure for any competent handyperson. However, should you have any doubts about your ability to tackle the task we suggest you engage a suitably qualified professional.

Tools required:

1. 17mm ring spanner or a suitable adjustable spanner
2. Slotted screw driver
3. Plumbers grips

The valve change procedure- hot valve

1. Turn off the hot water supply.
2. Remove the index (A) from the centre of the handle by inserting a small flat bladed screwdriver at the edge and carefully prising it out.
3. Unscrew and remove the handle retaining screw (B).
4. Remove the handle (C).
5. Unscrew the old valve (D) using a 17 mm spanner or a suitable adjustable one. Bear in mind that it might take some initial force to free the valve if it has been in place for some time.
6. Screw the valve into its correct location.
7. Refit handle (C), tighten screw (B) with the slotted screwdriver and reposition index (A).
8. Turn the hot water supply back on and check for leaks.

The valve change procedure- cold/ filtered valve

1. Turn off the cold water supply .
2. Remove the index (E) from the centre of the handle by inserting a small flat bladed screwdriver at the edge and carefully prising it out.
3. Unscrew and remove the handle retaining screw (F).
4. Remove the handle (G).
5. Unscrew the collar (H) using plumbers grips.
6. Unscrew the old valve (I) using a 17 mm spanner or a suitable adjustable one. Bear in mind that it might take some initial force to free the valve if it has been in place for some time.
7. Screw in the new valve (I) whilst ensuring the raised lug is aligned with the hole within the tap body.
8. Tighten the collar (H) and reposition handle (G).
9. Tighten screw (F) with the slotted screwdriver and then reposition indice (E).
10. Turn the water supply back on and check for leaks.



FRANKE FILTERFLOW

KITCHEN
SYSTEMS

Franke FilterFlow 3 Old Winery Business Park, Chapel Street,
Cawston, Norfolk, NR10 4FE
Phone +44 (0) 1603 875 468 Fax +44 (0) 844 358 0166
Email: info@frankefilterflow.co.uk