

FRANKE FILTERFLOW

Spout Seal Kit Change Guide - Corinthian and Doric

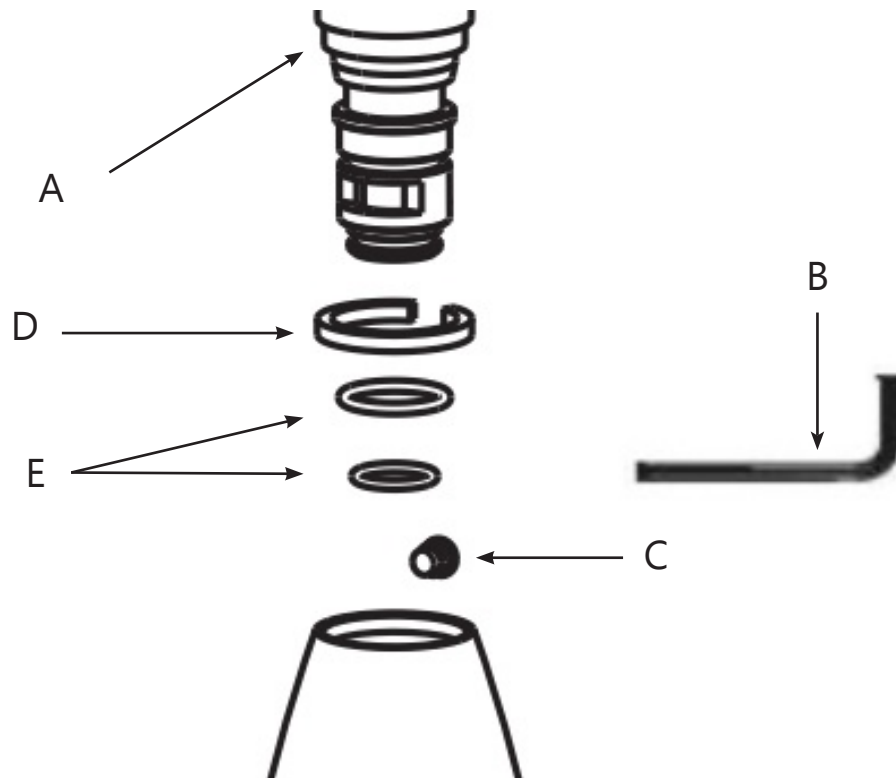

Before you begin

Replacing the spout seals is a straightforward procedure for any competent handyperson. However, should you have any doubts about your ability to tackle the task we suggest you engage a suitably qualified professional.

The tools you will need

1. 2.5mm Allen Key

The spout seal kit change procedure

1. Turn off the water supply to the tap.
2. Use the 2.5mm Allen key (B) to unscrew the grub screw (C) located on the back of the tap where the spout enters the tap body.
3. Remove the spout (A) by pulling it securely upwards.
4. Remove the plastic bearing ring (D) and replace using the matching bearing ring from the kit. (2 different bearing rings are included, the smaller ring is redundant for this task) Align the gap in the clip with the hole in the tap body.
5. Remove the O-Seals (E) and replace them with the new seals (smear the new seals with the silicon grease from the sachet provided). This will extend the life of the new seals.
6. Insert the spout back into the body of the tap.
7. Replace the grub screw. This only needs to be inserted far enough to prevent the spout from coming out, it is not intended to screw into the spout surface.
8. Turn the water supply back on and check for leaks.



GRL Direct
+44 (0)1603 875468
contact@grldirect.co.uk
www.grldirect.co.uk